



RS-390/395SA

OUTPUT: APPROX 1.0~40W

Carbon Brush Motors

代表的用途: 自动车电装机器
家用电器、泵

Automotive Products
Household Appliances



MODEL	VOLTAGE		NO LOAD		AT MAXIMUM EFFICIENCY				STALL	
	OPERATING RANGE	NOMINAL	SPEED	CURRENT	SPEED	CURRENT	TORQUE	OUTPUT	TORQUE	CURRENT
			r/min	A	r/min	A	g. cm	W	g. cm	A
RS-395SA-2056	6-14V	12.0V	7500	0.13	6375	0.708	85	5.54	565	3.9
RS-390SA-23144	8-16V	14.0V	8000	0.14	6640	0.711	102	6.95	600	3.5

UNIT: MILLIMETERS

旋转方向
Direction Of Rotation

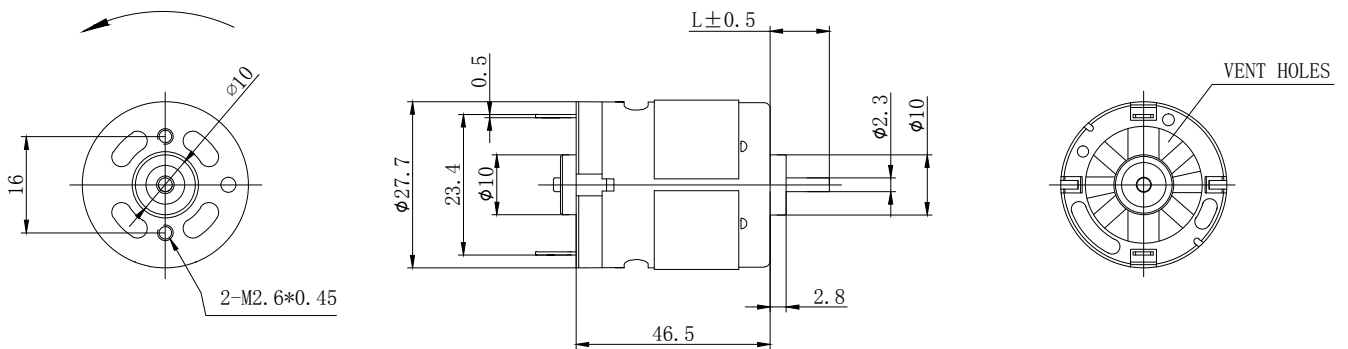

WEIGHT: 80g (APPROX)

RS-390SA-23144

14.0V

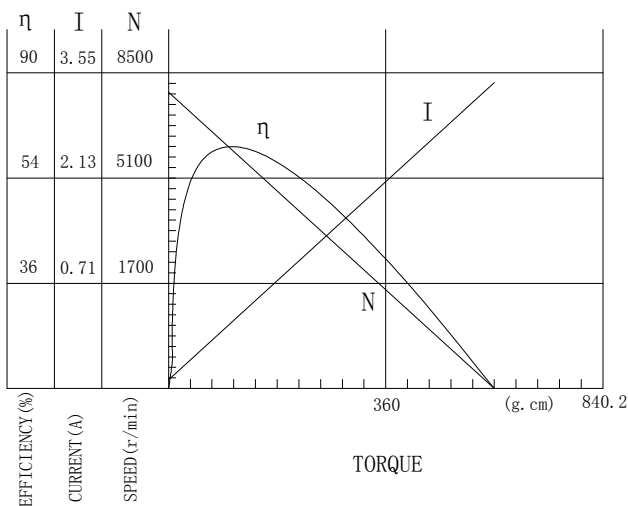

RS-395SA-2056

12V

