



RS-540/545SM

OUTPUT: APPROX 2.0~65W

Precious metal-brush motors

代表的用途: 家用电器
电动工具

Typical Applications/Household Appliances
Cordless Power Tools



MODEL	VOLTAGE		NO LOAD		AT MAXIMUM EFFICIENCY				STALL	
	OPERATING RANGE	NOMINAL	SPEED	CURRENT	SPEED	CURRENT	TORQUE	OUTPUT	TORQUE	CURRENT
			r/min	A	r/min	A	g. cm	W	g. cm	A
RS-540SM-7516	2.4-4.5V	3.6V	20200	2.90	16300	12.2	154	25.7	800	51.0
RS-540SM-5045	4.5-12V	12V	17500	0.95	15100	5.93	325	50.3	2350	37.0
RS-545SM-4522	3.6-12V	10V	23300	1.20	19100	5.60	180	35.3	1020	26.0

UNIT: MILLIMETERS

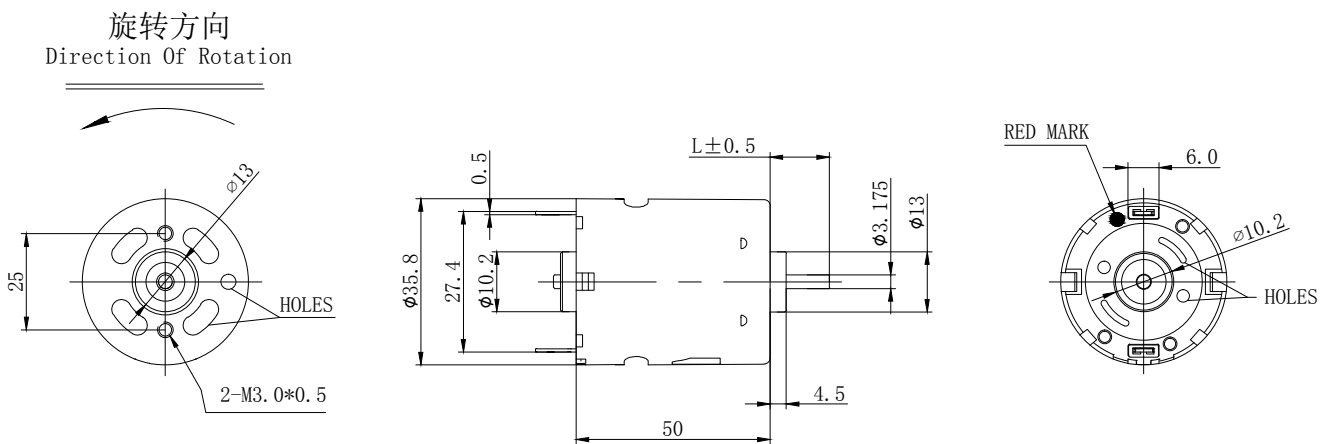

WEIGHT: 160g (APPROX)

RS-540SM-7516

3.6V

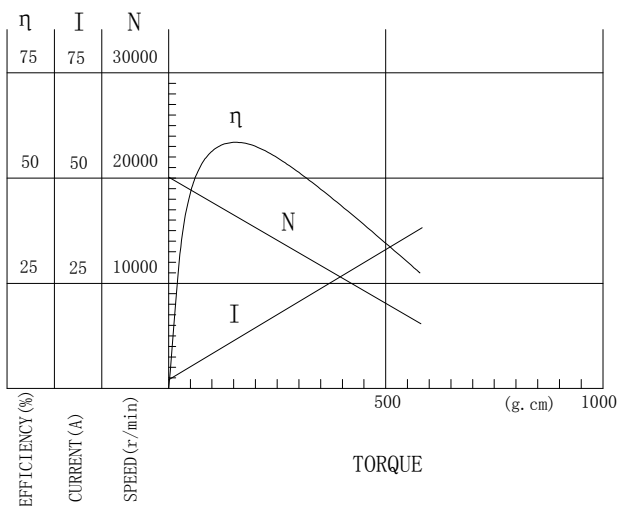

RS-545SM-5045

12V

