



# RF/RK-528TB

OUTPUT: APPROX 0.5~25W

Precious metal/Carbon-brush motors

代表的用途: 喷香机、点钞机  
消防设备、泵

Aerosol dispenser Counting machine  
Fire fighting equipment



MODEL	VOLTAGE		NO LOAD		AT MAXIMUM EFFICIENCY				STALL	
	OPERATING RANGE	NOMINAL	SPEED r/min	CURRENT A	SPEED r/min	CURRENT A	TORQUE mN.m	OUTPUT W	TORQUE g.cm	CURRENT A
RK-528TB-16430	23-25V	24V	6400	0.024	5572	0.159	5.07	2.74	394	1.05
RK-528TB-3570	3.5-5.5V	4.5V	7400	0.160	6183	0.848	4.12	2.51	265	4.49

UNIT: MILLIMETERS

旋转方向  
Direction Of Rotation

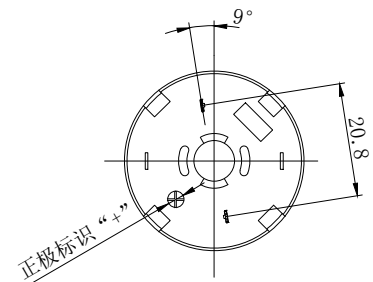
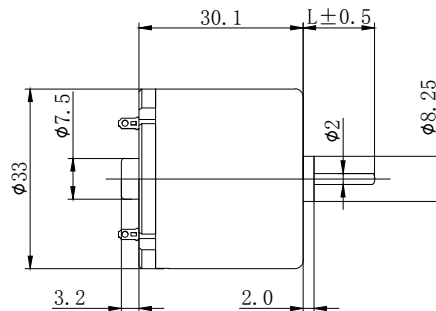
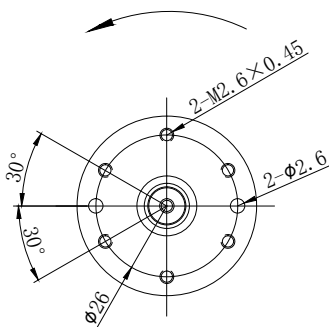

WEIGHT: 79g (APPROX)

RK-528TB-16430

24V

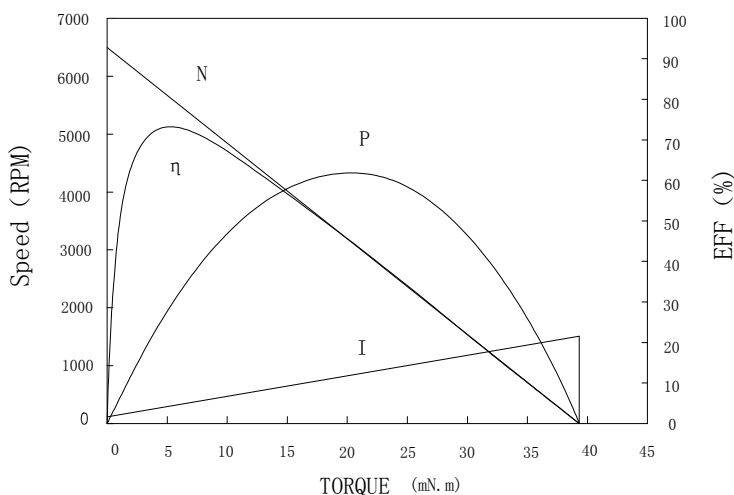

At No Load

Speed: 6415 RPM  
Current: 0.024 AMPS

At stall (Extrapolated)

Torque: 38.57 mN.m  
Current: 1.047 AMPS

At maximum efficiency

Efficiency: 72.0 %  
Torque: 5.071 mN.m  
Speed: 5572 RPM  
Current: 0.159 AMPS  
Output: 2.74 Watts

At maximum Power output

Output: 5.999 Watts  
Torque: 19.285 mN.m  
Speed: 3358 RPM  
Current: 0.51 AMPS

Characteristics

Torque constant  $K_t$ : 37.693 mN.m/APM  
E. M. F. constant  $E_c$ : 37.693 mV/rad/sec  
Dynamic resistance: 22.9171 Ohms  
Motor regulation  $M_r$ : 166.33 RPM/mN.m